

1 LOCATION MAP  
N.T.S.

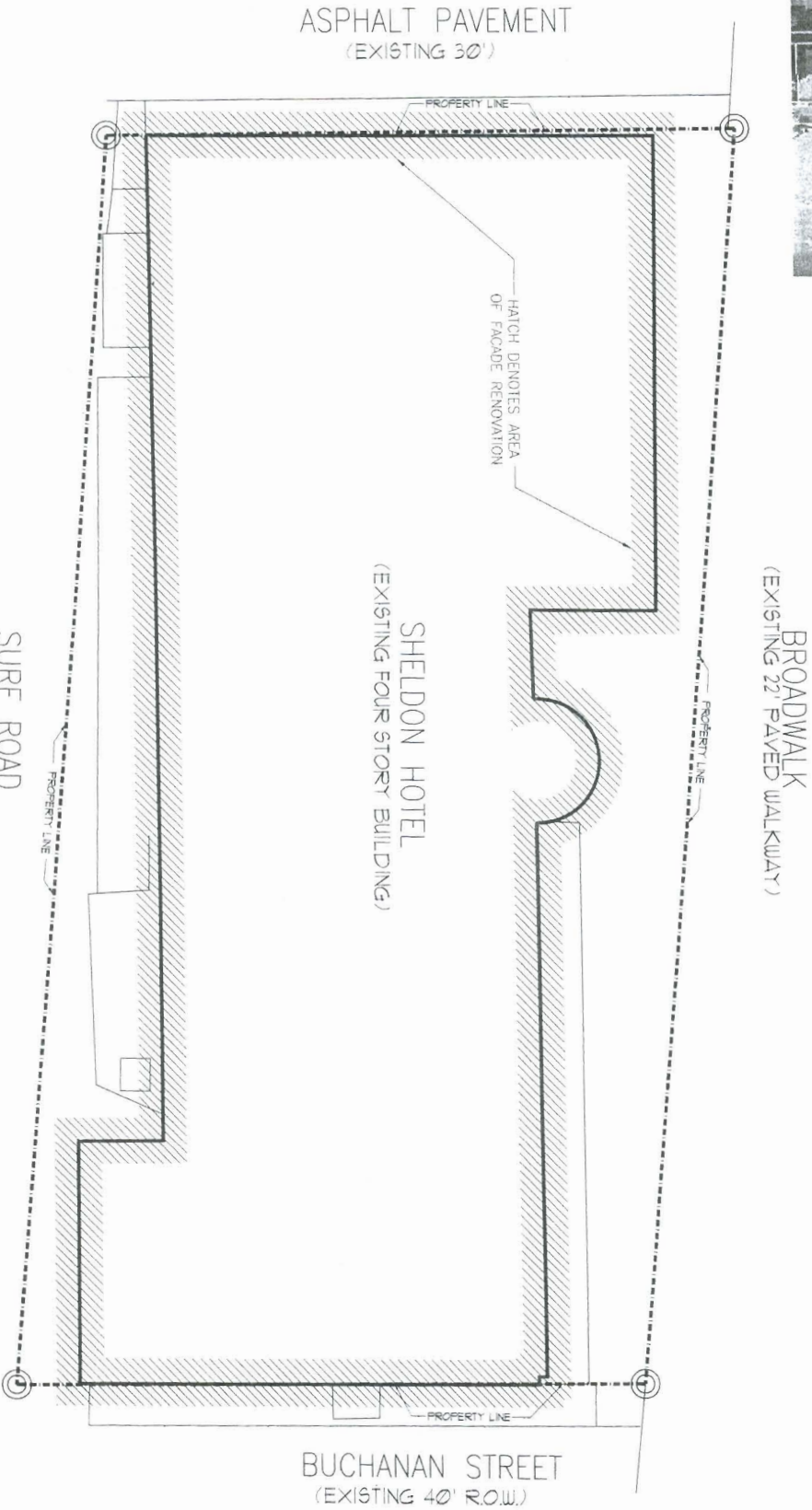

2 EXISTING SITE PLAN  
SCALE: 1" = 10'



JOSEPH B. KALLER  
ASSOCIATES PA  
P.O. BOX 1122  
HOLLYWOOD, FL 33022  
(954) 966-1341  
www.kallerassociates.com

SEAL

JOSEPH B. KALLER  
LICENSED PROFESSIONAL ENGINEER  
FLORIDA LICENSE # 0000729

PROJECT TITLE  
RENOVATION  
THE SHELDON HOTEL  
1000 N. BROADWALK  
HOLLYWOOD FL 33019

SHEET TITLE  
SITE PLAN

REVISIONS	
NO.	DATE / DESCRIPTION
1	3/21/20 10% SUBMISSION

PROJECT NO.: 10015  
DATE: 5/27/20  
DRAWN BY: TMS  
CHECKED BY: 2BK

SHEET

SP-1.0



1 OF 1